

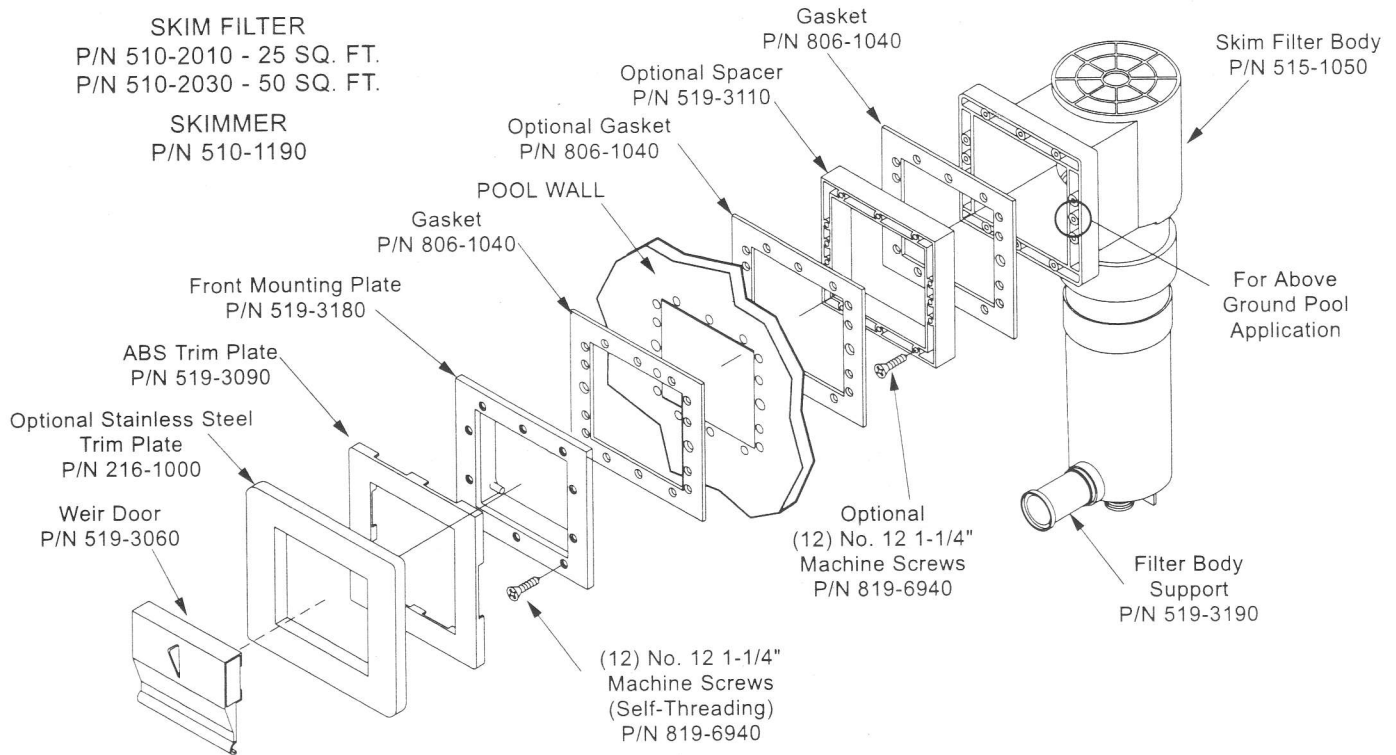

# Waterway

2200 East Sturgis Road, Oxnard CA. 93030

## INSTALLATION INSTRUCTIONS FRONT ACCESS SKIM FILTER & SKIMMER



**NOTE:** Model shown here is a Skim Filter. Installation instructions are identical for any size of Skim Filter or Skimmer. To insure the correct installation, please take the time to read the following instructions:

- A. Find a flat surface, at least 8" x 8", along pool wall where at least 4" of the Skim Filter / Skimmer lid is not in an accessible area, it is advised to glue it in place using ABS glue.
- B. Using a jig saw, cut a hole through the wall 6" wide x 5-1/2" high so that the back of front mounting plate will fit through the wall.
- C. Using the front mounting plate as a template, mark the 10 holes using a marker, then drill holes using a 1/4" drill bit (make sure the drill is held perpendicular to the wall) unless holes are pre-punched.
- D. Apply silicone to all mounting surfaces and gaskets, if desired.
- E. After installing vinyl on, holding Skim Filter / Skimmer in place insert (2) screws through pool wall into center right side, then place front mounting plate on wall.
- F. Screw the remaining (10) self-threading No. 12 machine screws through the front plate and into the Skim Filter / Skimmer body. Make sure not to over tighten.
- G. Clean off excess silicone if used.
- H. Use either an ABS trim plate or a Stainless Steel trim plate to cover front mounting plate, if desired. ABS trim plate snaps over the mounting plate, Stainless Steel trim plate has self-adhesive backing.
- I. Use the filter body support to keep skimmer from bending pool wall.
- J. For winterizing, drain the pool approximately 2" below the Skim Filter / Skimmer opening. Remove and store the basket and weir indoors.
- K. Disconnect all hoses from the Skim Filter / Skimmer to make sure that all water is kept free from the Skim Filter / Skimmer bodies to prevent formation of ice inside, which will crack the Skim Filter / Skimmer Bodies. Warranty does not include ice formation damage.
- L. The winterizing plate (not included) screws securely in place, using the same (10) No. 12 self-threading machine screws, provided with the assembly.

Winterizing Plate  
(not included)  
P/N 519-3020

